

Order no.: 115139

Folding scaffolding 0.75 x  
1.80 m with outrigger  
Platform height 4.04 m

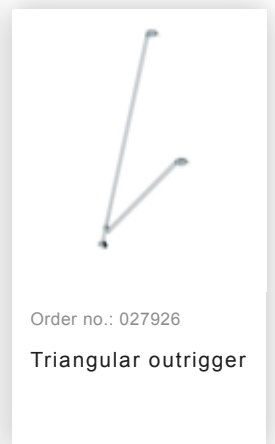

### Accessories for the product family

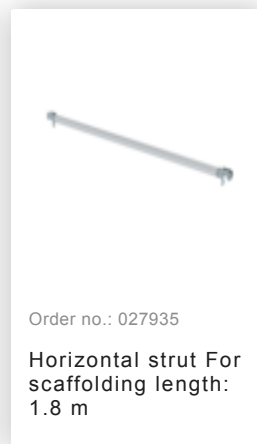
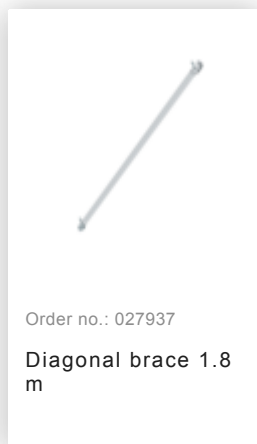
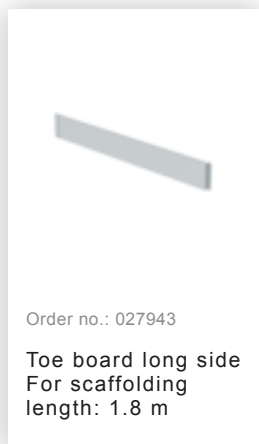
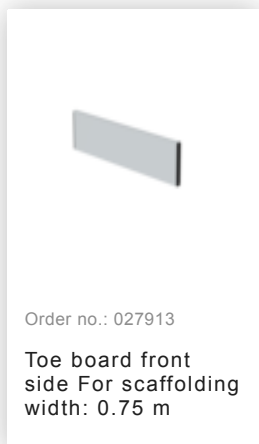
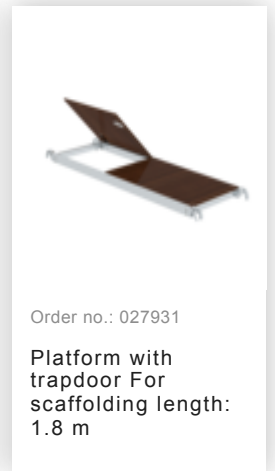
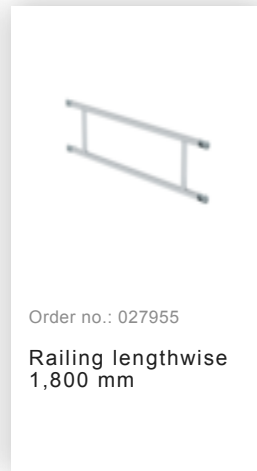
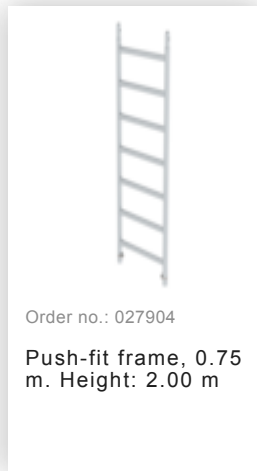
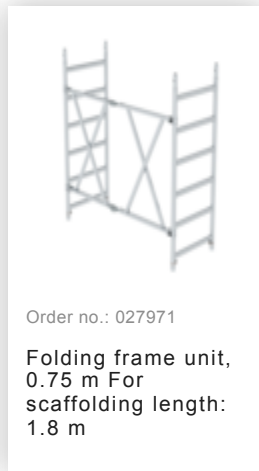
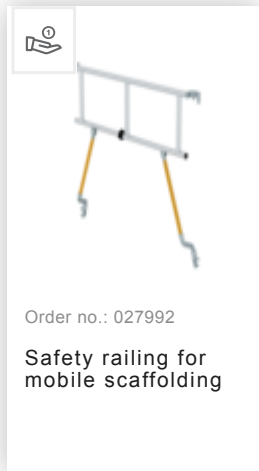



Order no.: 027973

Swivel castor with spindle height adjustable Ø 125 mm



Order no.: 027940

Step-on bracket



Order no.: 027912

Ballast weight with hanging brackets RAL 1021

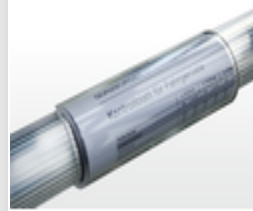

Order no.: 019081

Clip tray for tubes Ø 50 mm



Order no.: 027920

Wall spacer adjustable Adjustable up to 1.0 m



Order no.: 070506

Frame extension can be clamped on Adjustment range max. 400 mm



Order no.: 019274

Storage tray 500 x 220 mm Clamping range 38–51 mm



Order no.: 019276

Storage tray 800 x 300 mm Clamping range 38–51 mm



Order no.: 019175

Inspection sticker 40 x 40 mm



Order no.: 019176

Inventory sticker

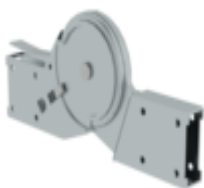

Order no.: 019477

Automatic steel hinge for scaffolding folding frame



Order no.: 070507

Safety door on front side Push-fit frame 0.75



Order no.: 019136

Spring clip for mobile scaffolding with short pin, closed



Order no.: 019137

Spring clip for mobile scaffolding with long pin, open



Order no.: 070524

Scaffolding strut telescopic 1,700–2,500 mm



Order no.: 027104

**Height-adjustable  
spindle**



Order no.: 027922

**Swivel castor with  
spindle, non-  
marking grey height  
adjustable Ø 200  
mm**



Order no.: 027921

**Swivel castor with  
spindle, electrically  
conductive height  
adjustable Ø 200  
mm**



Order no.: 027958

**Swivel castor Ø  
200 mm With  
parking brake and  
pin**



Order no.: 027905

**Push-fit frame, 0.75  
m. Height: 1.00 m**